

Technical Data:

- Voltage: 110-120 V AC 60 Hz
- Rated power: 68 W
- Noise level: <66 dB(A)
- Unit dimension: 22"H x 9.9"W x 10.9"D
- Unit weight: 15.5 lbs.

Medify Air
579 Route 22 West
North Plainfield, NJ 07060
(302) 659-8104
info@medifyair.com
www.medifyair.com

Medify Air

Model: MA-40^{V2.0}

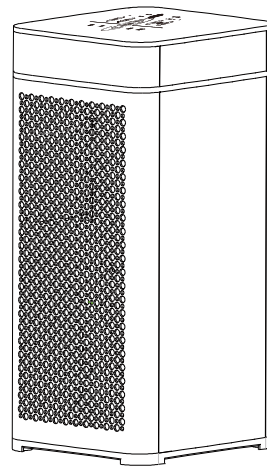

Read this manual before using.
Operate the unit according to the instructions provided.
Keep this for future reference.

User Manual

TABLE OF CONTENTS

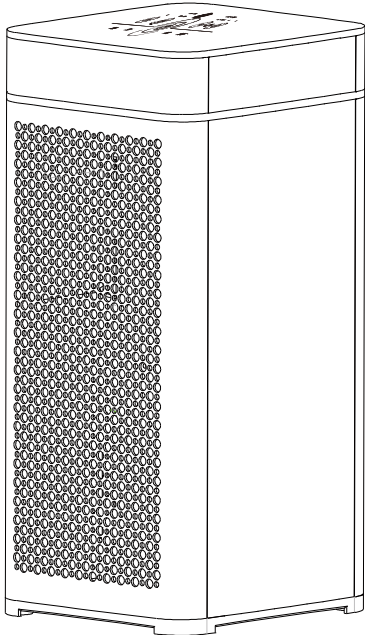

User Manual

1. Safety Precautions.....	3
2. Product Information.....	4
Control Panel.....	5
3. Before Use	6
Open and Replace back cover.....	6
Placement of air purifier.....	6
Install New Filter	7
4. Filter Purification Steps.....	9
5. How to Use.....	10
Control Panel Functions.....	10
Turning Off Air Purifier	10
Adjustment of Fan Speeds	11
Timer mode.....	11
Ionizer mode	11
Child-lock function.....	11
6. Maintenance and Cleaning.....	12
Clean the air purifier.....	12
Change filter.....	13
7. Warranty and service.....	15
Lifetime Warranty.. ..	16

User Manual

1. Safety Precautions

In order to avoid damage to you, others or property, follow the safety precautions.

If the power cord or unit is out of order, contact Medify Customer Service immediately.



WARNING



Do not touch power plug with wet hands.



Turn off the power before cleaning machine.



This is a 110v unit. It is NOT made for 220v use. Plugging into a 220v outlet will burn out the motor and circuits and the unit will no longer work. Only use with a 110v outlet



Keep machine dry.



Do not use air purifier in a room that is cooking with oils and grease that may clog the filters



Only a soft clean cloth is to be used. Do not use solvents like Benzene, Alcohol or any flammable cleaners to clean the air purifier



Do not use air purifier in rooms with fumigation or pesticide use.

Turn off power immediately in case of any of the following:

- Malfunction of any switch
- Circuit failure
- Abnormal heating of wires or plugs
- Any burnt smell, abnormal sound or shock
- Any other malfunction

User Manual

2. Product Information

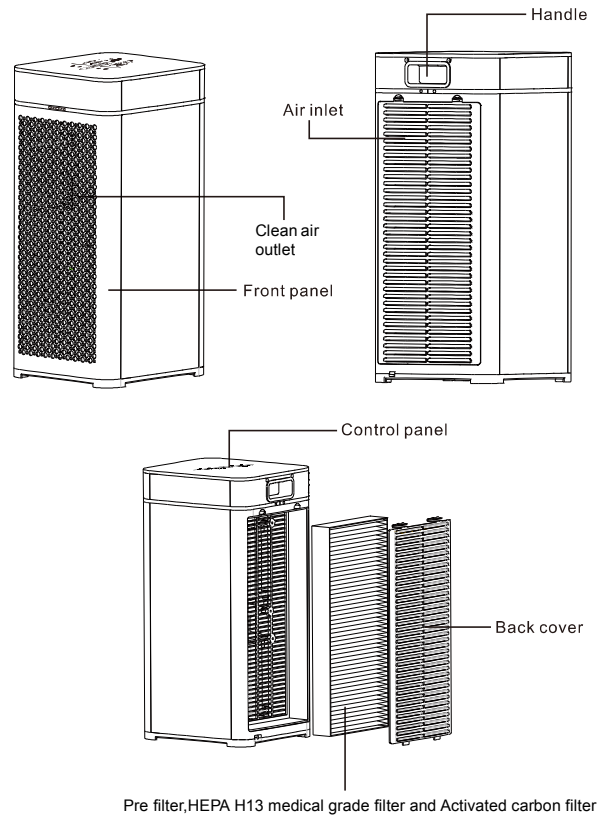

User Manual

Functional description of control panel

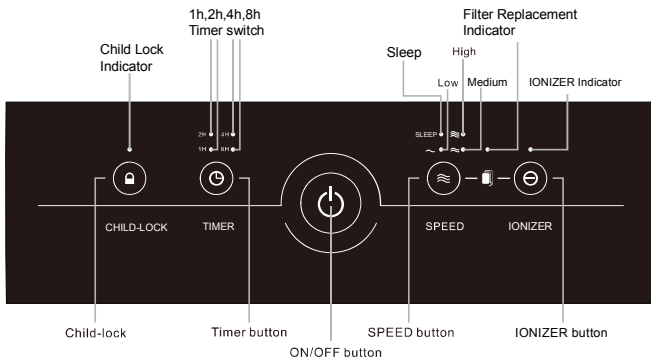

User Manual

3. Before Use

Open and Replace back cover

1. Press tabs on the back cover and pull on the cover. Then lift the back cover and pull out slightly.

2. To reinstall back cover, align at fixed groove and insert cover into groove. Frame will snap into place using the top buttons.

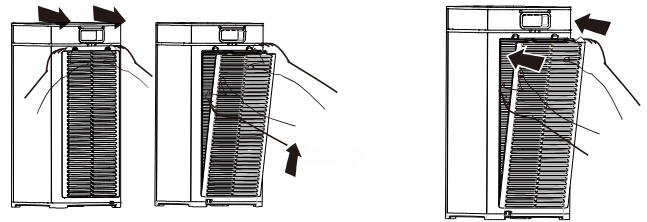

Placement of air purifier

Do not obstruct air intake or clean air outlet.

To ensure proper air circulation, leave at least 10" space between wall or furniture and back air intake.

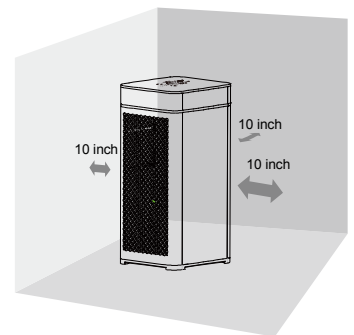

User Manual

Install filter

The 3 stage Medify filter is a one-piece filter for higher performance. Remove by pulling on the small tab at top. When reinstalling, make sure to push back in and make sure it is in snug for maximum performance.



Attention

Remove all plastic packaging from filter before installing.
Do Not run the air purifier when no filter is installed.

1. Place the machine in a dry location on a smooth and flat surface.



2. Press top buttons in the back cover and pull the cover. Lift the back cover and pull out slightly.

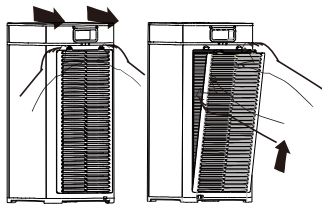

3. Remove filter by pulling on small tab at top of filter.

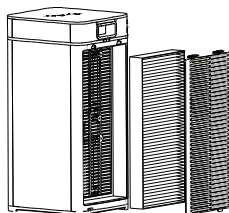

User Manual

4. Remove plastic packaging from the new filter before installing into the air purifier.

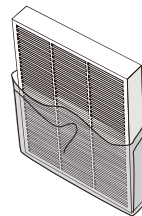

6. Replace back cover

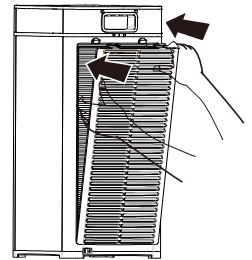

5. Place new filter into the air purifier with white side facing out to you. The tab at top of filter should be facing you.

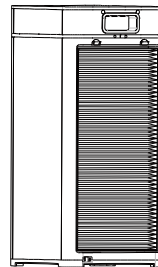

User Manual

4. Filter Purification: Four Steps

First step: Pre filter
Second step: True HEPA h13 Filter
Third step: Activated carbon filter
Fourth step: Ionizer

1. Pre-Filter

Removes large particles such as: Dust, Dander, Hair and others

2. True HEPA h13 Filter

HEPA H13 is a higher Grade of HEPA than Hepa Type or True HEPA.

3. Activated Carbon Filter

Absorbs odors, harmful VOCs, and other toxic substances such as formaldehyde.

4. Ionizer

Produces negative ions to neutralize positively charged particles such as dust, bacteria, mold spores, pollen, animal dander and other airborne positive particles.

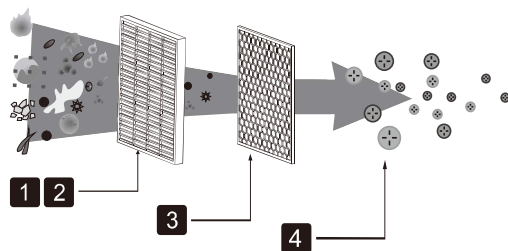

User Manual

5. How to Use

Control panel

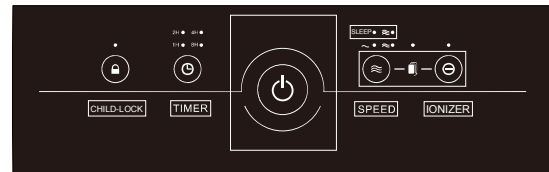

Plugging In

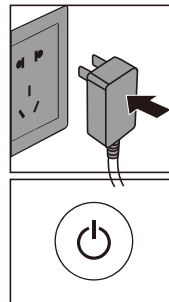

After plugging in, the air purifier will beep. All the indicator lights will flash 1 time, including the power light indicator. Then machine enters the standby mode.

Turning On The Air Purifier

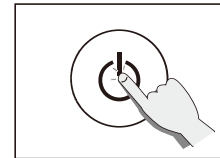

Press ON/OFF button and unit will turn on. Machine starts to work in low speed. Press the button again, machine stops and is in standby mode.

User Manual

Manual adjustment of fan

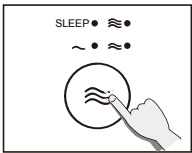

Press speed button to choose your speed. Options are: 1,2,3 and Sleep Mode.

Child-lock function

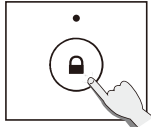

In this mode, none of the function keys can be used or changed. (Except the child lock function). To turn on the child lock, hold the button down for 3 to 5 seconds. To turn off the child lock function, hold the button down for 30 to 45 seconds.

TIMER mode

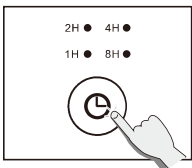

Press timer button and choose hour options: 1, 2, 4, 8 or no timer

Ionizer Mode

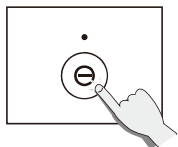

Ionizer is an On/Off function. You can choose to leave it on or off at your discretion. When ionizer is on, the indic light will be lit.

User Manual

6. Maintenance and Cleaning

Unplug air purifier before cleaning the unit.
Do not use excess water to clean the unit.
Use a soft cloth or a soft moist cloth to wipe down unit. Do not use cleaners or chemicals on the air purifier at any time.

Cleaning Your Air Purifier

From time to time if you see excess dust accumulate on the unit, wipe with a clean dry cloth. Also make sure air intake and vents are free from excess dust. Do not vacuum or try and wash filter as it will clog filter.

User Manual

Change filter

Indicator Icon

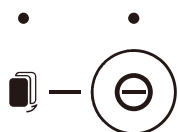

Reminds user when filter needs replacement.

Indicator Icon will become lit when filter needs to be changed.

Operating steps

1. Indicator Lights will show the user if filters need to be replaced.

2. Make sure to unplug before changing filter

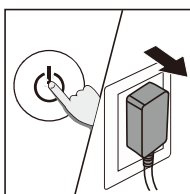

3. Press the top buttons on the back cover and pull the cover. Lift the back cover and pull out slightly.

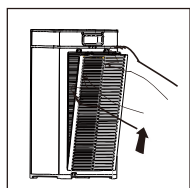

User Manual

4. Remove old filter from the unit. Pull on the tab at the top to remove.

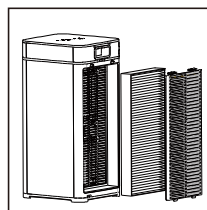

5. Remove plastic packaging from the new filter before installing into the air purifier. Place new filter into the air purifier with white side facing out to you. The tab at top of filter should be facing you.

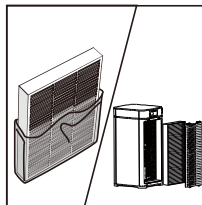

6. Replace back cover

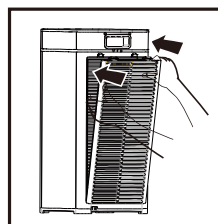

7. Reset Filter indicator Light:

After new filter is installed and unit is turned back on: Hold down the FAN SPEED button and the IONIZER button at the same time for 3-5 seconds and the indicator light will go off and timer is reset for 3000 hours

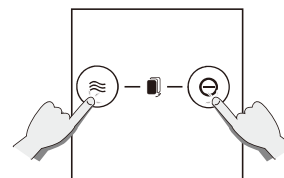
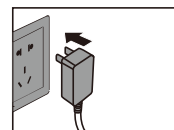

User Manual

7. Warranty and service

If you have any additional questions, please contact customer service.

All names and trademarks are property of Medify Air. Our company reserves the right to change the product at any time, without prior notice, and the company has no obligation to adjust products supplied earlier.

Please refer to detailed warranty terms on the following page.

To register for the lifetime warranty, please fill out the attach form and mail to:

Medify Air
579 Route 22 West
North Plainfield, NJ 07060

Or complete lifetime warranty registration available on our website (preferred method)
www.medifyair.com

User Manual

Lifetime warranty

Medify guarantees your Medify Air Purifier to be free of defects in material or workmanship for a lifetime period, provided you have completed and returned your warranty registration to Medify Air within the first 30 days of purchase, and that the filters are replaced with original and genuine Medify Air replacement filters at least once every six(6)months of after 3,000 hours of use. The filter replacement indicator will let you know when it is time to change. days, Medify Air will replace the defective unit at no charge to you and reimburse you for any shipping charges. After 30 days, Medify Air's obligation and liability under this Lifetime Warranty is dependent on your use of our genuine filters, purchased on our website or from our authorized resellers, which can be found on our website.

Our Lifetime Warranty remains in effect as long as:

1. You submit your warranty registration to Medify Air within 30 days of purchase.
2. You change filters with genuine and original Medify Air replacement filters at least once every six (6) months or after 3,000 hours of use (whichever comes first).
3. You use a proper power supply based on voltage: 110-120 V (North America & Japan).
4. There is no evidence of tampering, mishandling, neglect, accidental damage, modification, and/or repair done to the Medify Air Purifier by anyone other than authorized Medify Air service personnel.
5. Your air purifier is operated in accordance with the provided instructions.

This Lifetime Warranty is provided by:
Medify Air, 8 The Green, Dover, DE 19901.